

# mQuvée

## **WINE CELLAR**

INSTRUCTION MANUAL

## **VINLAGRINGSSKÅP**

INSTRUKTIONSANVISNING

## **VINKÆLDER**

INSTRUKTIONSMANUAL

## **VINKJELLER**

BRUKERHÅNDBOK

## **VIINIKAAPPI**

KÄYTTÖOHJE

## **WEINKLIMASCHRANK**

GEBRAUCHSANWEISUNG

## **CAVAS DE VINO**

MANUAL DEL USUARIO

## **CAVE A VIN**

MANUEL D'UTILISATION

## **CANTINETTA PER VINO**

MANUALE DI ISTRUZIONI

**WS150, WS190, WS380**

**Lindström & Sondén AB**

Havsbadsvägen 1, 262 63 Ängelholm, Sweden

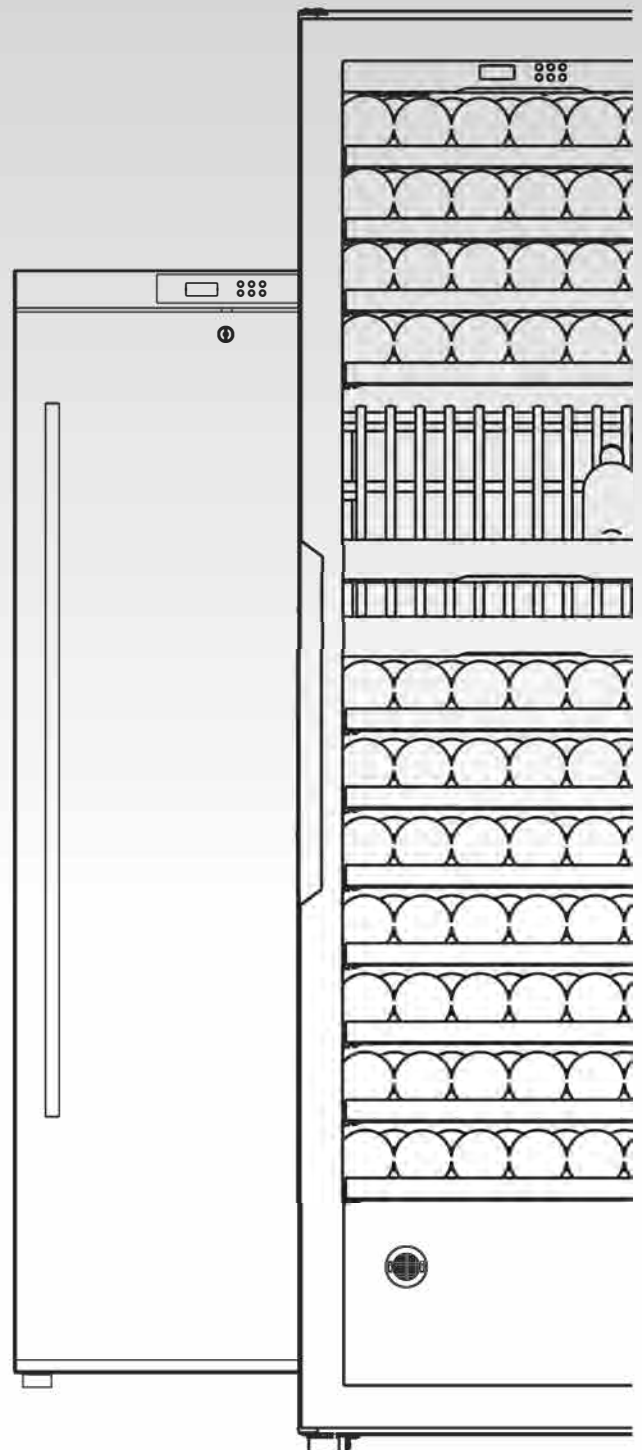

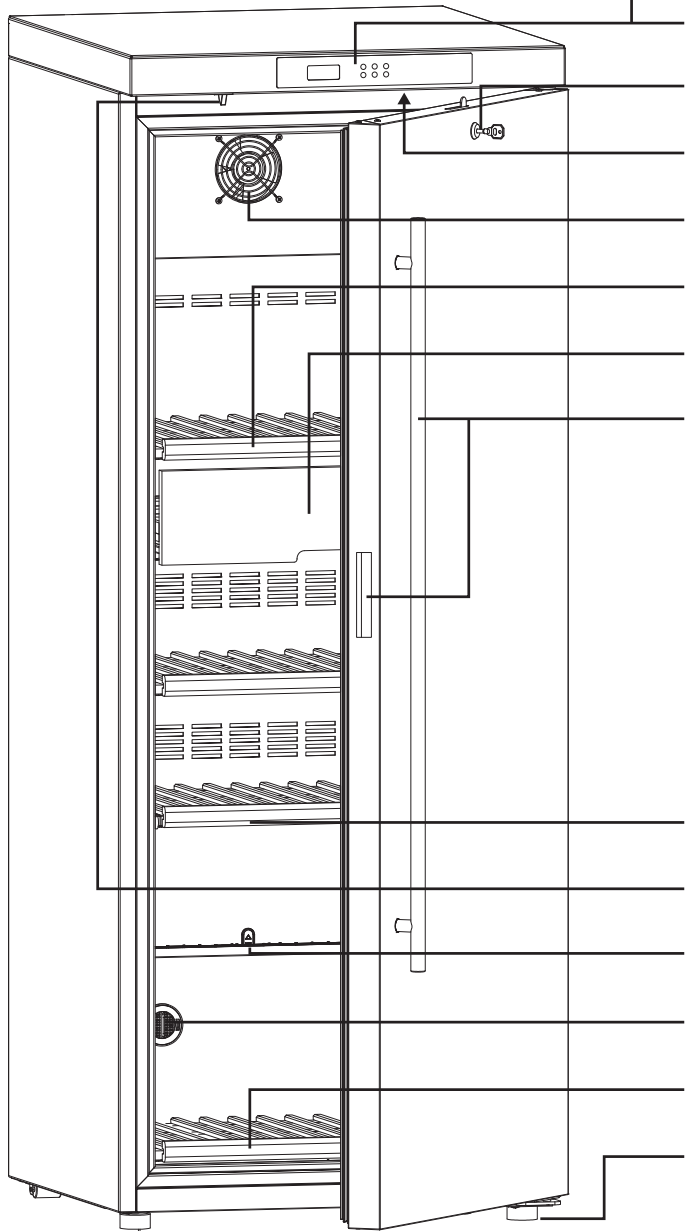
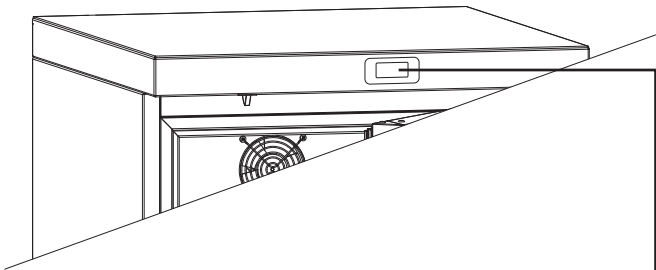

- A
- D
- C
- K
- E
- G
- F

- L
- B
- I
- J
- M
- H

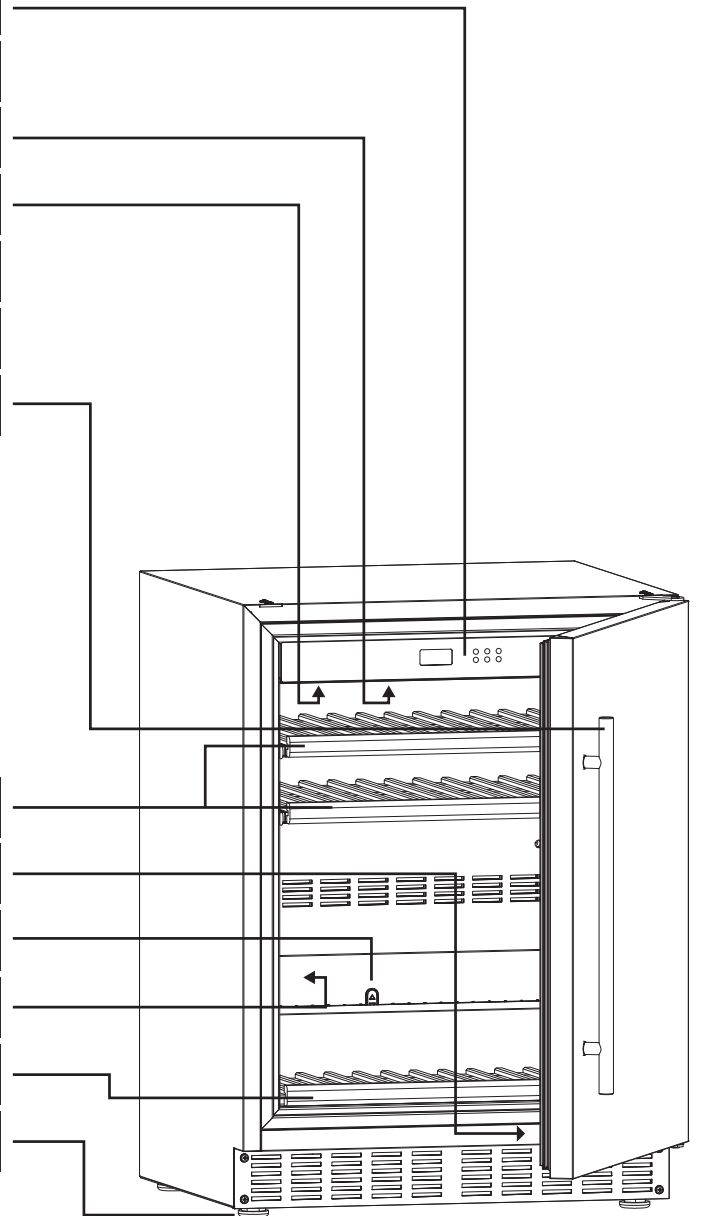

A

B

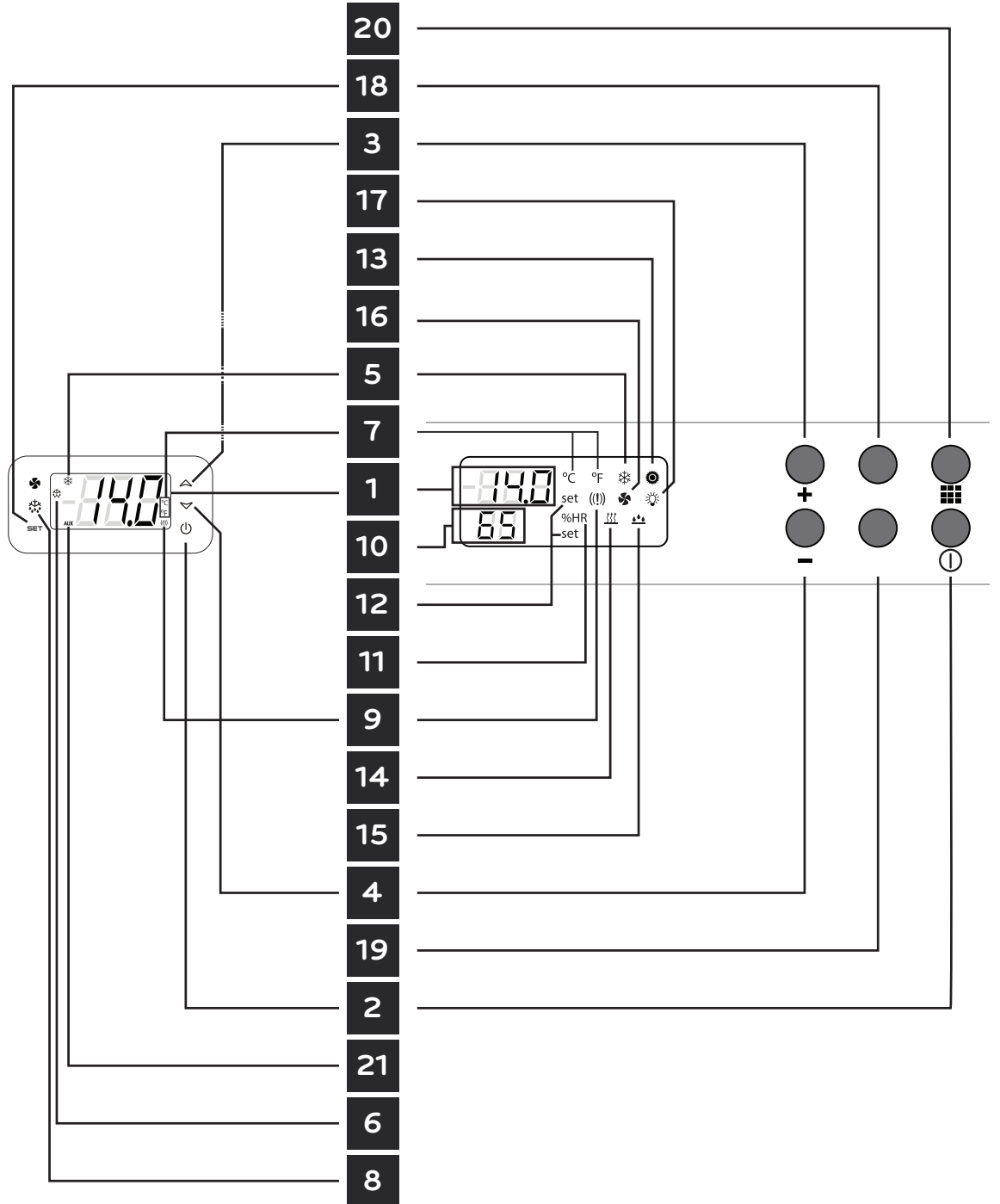

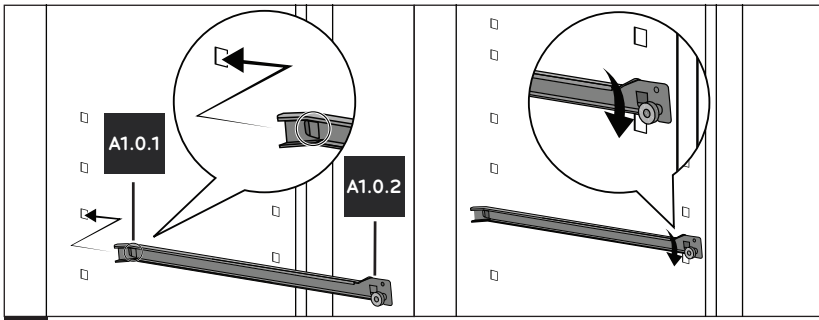

A 1.0

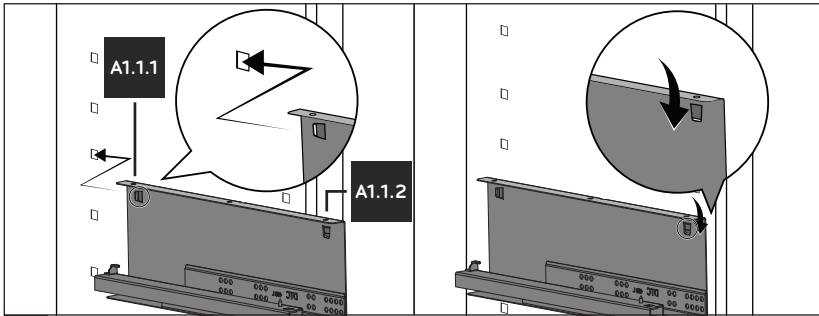
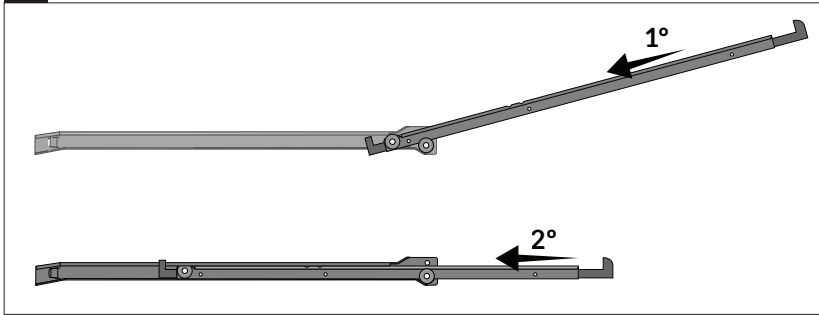

A 1.1

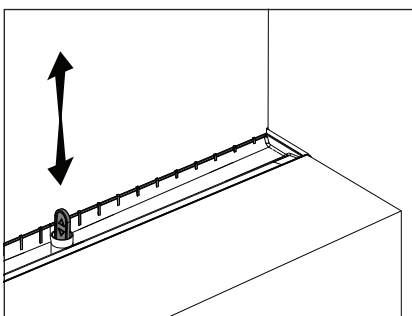
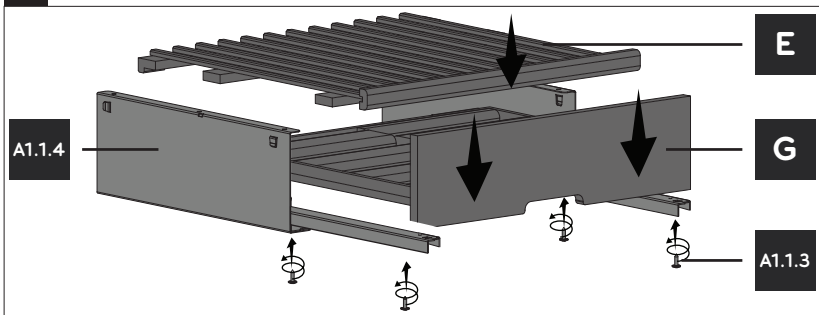

C 1.0

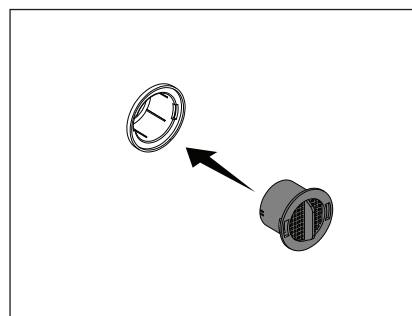

D 1.0

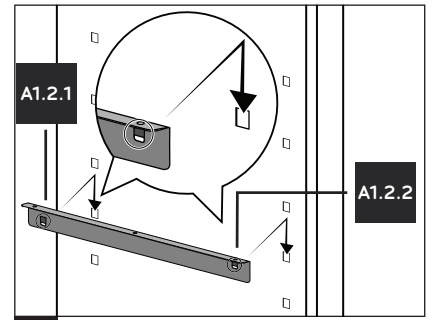

A 1.2

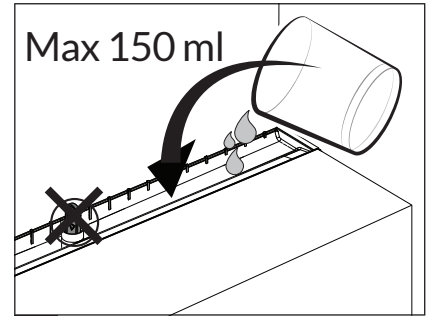
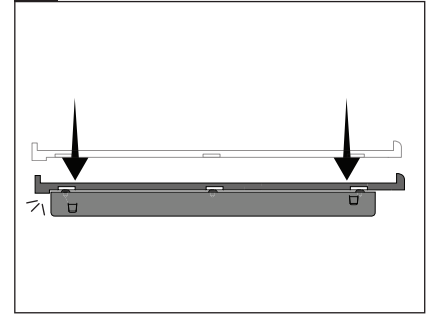

B 1.0

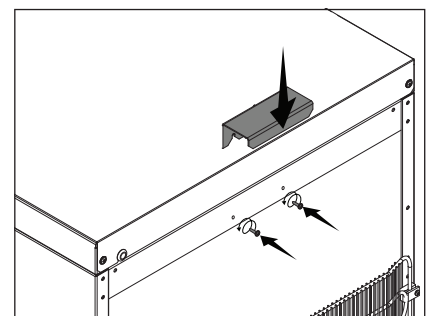

E 1.0

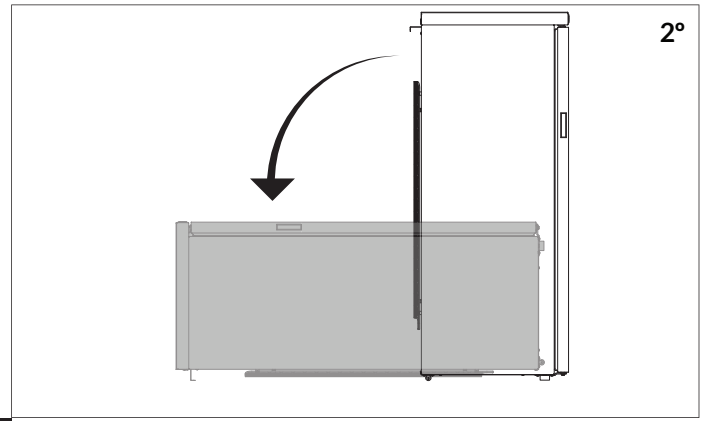
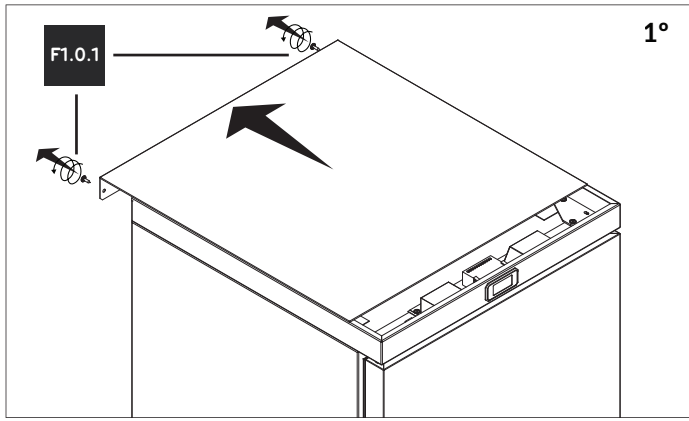

F1.0

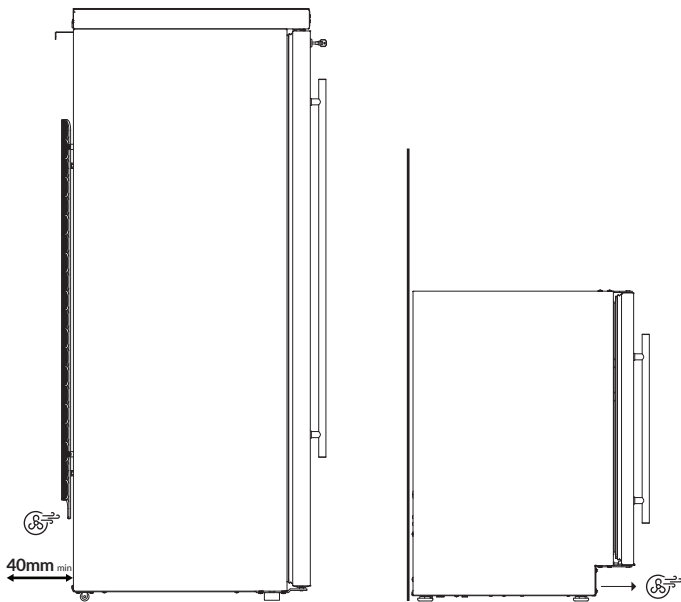
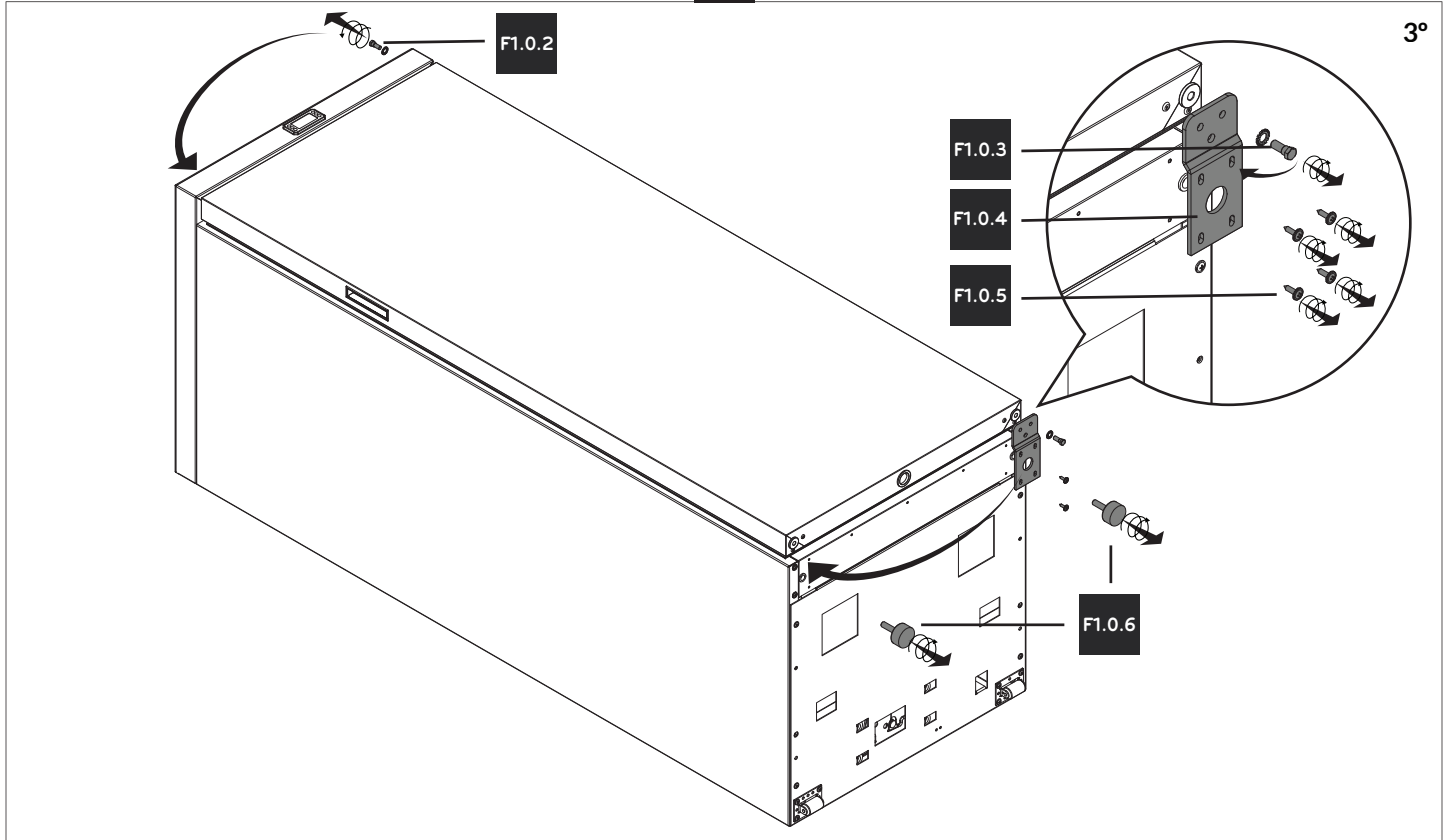

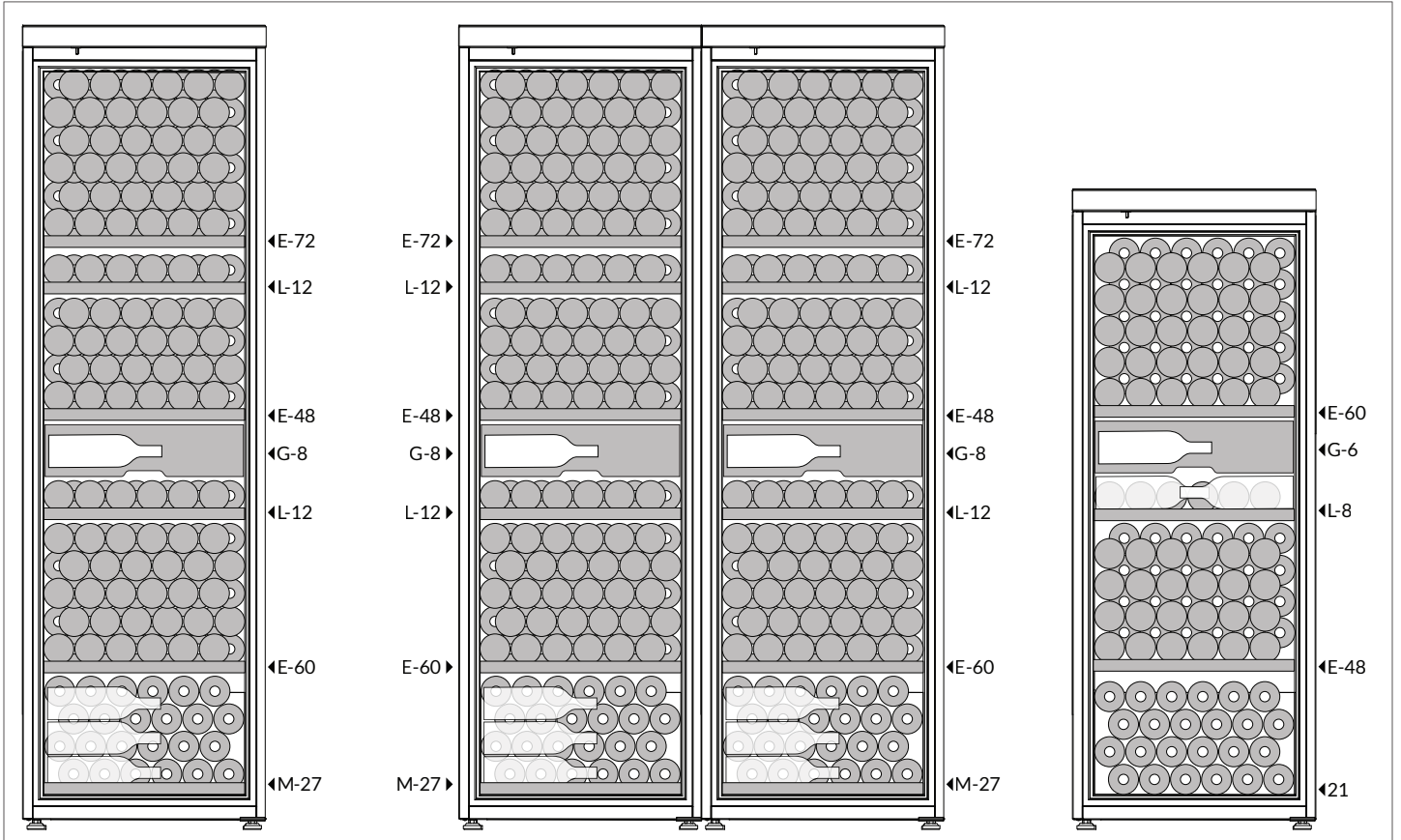

G 1.0

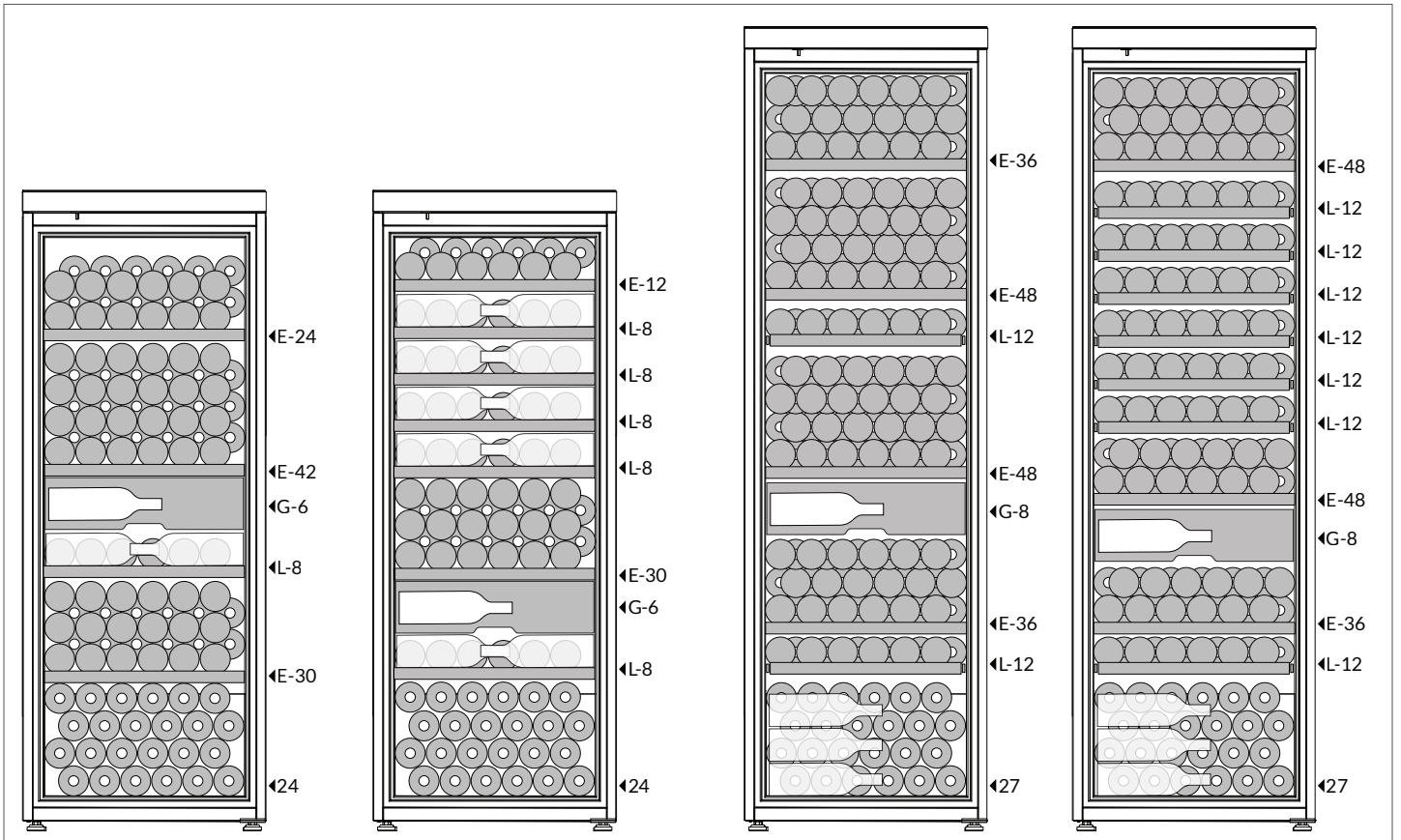

G 1.1

|                                  |   |
|----------------------------------|---|
| SAFETY                           | 1 |
| CONGRATULATIONS                  | 2 |
| FUSE REPLACEMENT                 | 3 |
| INSTALLATION                     | 3 |
| THE APPLIANCE                    | 4 |
| SETTING UP THE APPLIANCE         | 4 |
| EFFICIENT USAGE OF THE APPLIANCE | 5 |

|  |   |
|--|---|
| ENERGY SAVING                              | 6 |
| MAINTAINING THE APPLIANCE                  | 6 |
| TROUBLESHOOTING                            | 7 |
| END OF LIFE AND DISPOSAL OF WASTE MATERIAL | 8 |
| CUSTOMER SERVICE                           | 8 |
| TECHNICAL DATA                             | 9 |
| REVERSING THE DOOR                         | 9 |

## SAFETY

### ATTENTION

**Read your manual carefully since it contains instructions to ensure safe installation, use and maintenance of your appliance.**

Your appliance is built under International safety standards (2014/35/EU).

It also meets the EC standards on the prevention and elimination of radio interference (2014/30/EU).

- Keep this manual as a reference for future use.

- The manufacturer reserves the right to modify the characteristics of the models without prior notice.

- Some models may not have all the accessories indicated.

**Warning: this appliance must be earthed.**

**1.** This appliance is designed to be used indoors and under no circumstances should it be installed outside, even if protected by a roof. Leaving the appliance exposed to the rain and weather is exceedingly dangerous.

**2. Warning: This appliance can be used by children with age of 8 and above and people with physical, sensory or mental abilities reduced or lack of experience and knowledge, if have given proper supervision and training regarding the use of appliance in a safe way and understand the dangers involved.**

Cleanliness and **maintenance to be carried out by the user** should not

be carried out by children without supervision.

**3.** Do not attempt to operate or handle this appliance when barefoot, or with wet hands or feet.

**4.** It is highly recommended that you do not operate this appliance by connecting it to the power supply with extensions or multiple socket plugs. If the appliance has been installed between two cabinets, make sure that the supply cord is not dangerously crimped or trapped beneath a heavy object.

**5.** Never pull the cable or the appliance to remove the plug from the socket; this is exceedingly dangerous.

**6.** Do not touch the internal cooling elements, especially if your hands are wet, since you could burn or hurt yourself. Do not place ice cubes straight from the freezer into your mouth as this may result in burns.

**7.** Before doing any cleaning, disconnect the appliance from the electricity (by pulling out the plug or turning off the general switch in your home).

**8.** Before disposing of your old appliance, remember to break or remove the lock as a safety measure to protect children who might lock themselves inside the appliance when playing. In addition, if the appliance is a new one with a lock, keep the key out of the reach of small children.

**9.** If your appliance is not operating properly, read the chapter entitled,

**“Troubleshooting”**, which might help you resolve the problem. Do not attempt to repair the appliance by tampering with the internal components.

**10.** If the supply cord is damaged, it must be replaced by the manufacturer, its service agent or similarly qualified persons in order to avoid a hazard.

**11. Warning: Do not use electric appliances inside the food storage compartments of the appliance, unless they are of the type recommended by the manufacturer.**

**12. Warning: Do not use mechanical devices or other means to accelerate the defrosting process, other than those recommended by the manufacturer.**

**13.** Do not store explosive substances such as aerosol cans with a flammable propellant in this appliance.

 Risk of fire, flammable materials.

**14.** This appliance is intended to be used in household and similar applications such as:

- staff kitchen areas in shops, offices and other working environments;
- farm houses and by clients in hotels, motels and other residential type

environments;

-bed and breakfast type environments;  
-catering and similar non-retail applications.

**15.** At the end of the functional life of your appliance - containing cyclopentane gas in the insulation foam and perhaps R600a gas (isobutane) in the refrigeration circuit - it should be made safe before being sent to the dump. For this operation, please contact your dealer or the Local Organization in charge of waste disposal in accordance with the rules in force (WEEE).

**16. Warning: Do not damage the refrigeration circuit.**

**17.** Children should be supervised to ensure that they do not play with the appliance.

**18. Warning: Keep ventilation openings, in the appliance enclosure or in the built-in structure, clean and clear of obstruction.**

**19.** The appliance must not be clean with steam.

**20.** This appliance must only be used to preserve and freeze food, following the instructions described in this manual.

## CONGRATULATIONS

You have purchased a wine cellar carefully developed for long-term storage of your wine.

You can also use it to bring wine to serving temperature. All you have to do is to change temperature set point.

This appliance is intended to be used exclusively for the storage of wine.

**Please read this manual carefully and keep it for future reference.**

**It contains important information for the installation, use and maintenance of your appliance.**

### Maturing Wine

Successful long-term storage of wine is a delicate process. Any sudden temperature change, cork sealing quality damage due to low humidity, exposure to light (particularly UV radiation) or abnormal vibration can change wine qualities.

Recommended maturing temperature is in the range of 10 to 14°C. Relative humidity should be above 50%, lower than this cork sealing will be at risk.

High humidity will damage your bottle labels.

As you will see later in this manual, the controller is pre-set to 12°C and 65% relative humidity. However, you will be able to adjust these conditions according to your needs.

### Serving Wine

Recommended serving temperature for white wine is 6 to 10°C. Red wine is normally served between 15 and 18°C.

Please consult a good manual or use wine label information in order to set the correct temperature for the specific wine you want to serve.

### Bottle Capacity

The number of bottles you are able to put in your wine cellar has been calculated using the standard number and layout of shelves and bottle dimension according to EN 62552:2013.

In chapter **“Efficient usage of the appliance”**, you have an overview of how this loading plan was made and also some other options if you want to increase the number or change the position of the shelves.



# FUSE REPLACEMENT

## (For UK Plug)

If the mains lead of this appliance is fitted with a BS 1363A 13-amp fused plug, to change a fuse in this type of plug use an A.S.T.A. approved fuse to BS 1362 type and proceed as follows:

1. Remove the fuse cover and fuse.
2. Fit replacement 13A fuse into fuse cover.
3. Refit both into plug.

Important: The fuse cover must be refitted when changing a fuse and if the fuse cover is lost the plug must not be used until a correct replacement is fitted. Correct replacement is identified by the colour insert or the colour embossed in words on the base of the plug. Replacement fuse covers are available from your local electrical store.

## Connection to a rewirable plug

If the fitted plug is not suitable for your socket outlet, then it should

be cut off and disposed of in order to avoid a possible shock hazard, should it be inserted into a 13A socket elsewhere. A suitable alternative plug should then be fitted to the cable. The wires in this mains lead are coloured in accordance with the following code:

BLUE - neutral ("N")

BROWN - live ("L")

GREEN AND YELLOW - earth ("E")

1. The GREEN AND YELLOW wire must be connected to the terminal in the plug which is marked with the letter "E" or by the Earth symbol or coloured green or green and yellow.

2. The BLUE wire must be connected to the terminal which is marked with the letter "N" or coloured black.

3. The BROWN wire must be connected to the terminal which is marked with the letter "L" or coloured BROWN or RED which is connected to the fuse.

# INSTALLATION

**To ensure that the appliance operates properly and to reduce energy consumption, it is important that the appliance is installed correctly.**

## Ventilation

The compressor and condenser generate heat and, therefore, need to be ventilated properly. Rooms with no ventilation are not suited for installation of the appliance. Therefore, it should be installed in a room with an opening (window or French window) that provide the appropriate amount of air re-circulation. It is also important to install it in a free humidity room.

During installation, make sure not to cover or obstruct the grid that allow for proper ventilation of the appliance. For proper ventilation of the appliance, leave a space of at least 10 cm, between the sides of the appliance and any adjacent cabinets/walls.

## Away from heat

Avoid positioning the appliance in a place where it is directly exposed to sunlight or near an oven, cook top or similar.

## Leveling

Install the appliance on a level and rigid floor. If the floor is not perfectly horizontal, adjust the refrigerator by tightening or loosening the front feet "H".

## Electrical and earth connection

The appliance should not be turned on right after transportation. Two hours is the advised time so that the oil from the motor-compressor gets back to its original position.

Before proceeding with the electrical connection, make sure that the voltage indicated on the rating plate, corresponds to the mains voltage in your home and that the socket is fitted with a standard earth wire, in accordance with safety standards. If the socket is not fitted with an earth wire, the manufacturer will not be held liability for any damages and or injuries arising out of the use of the appliance. Do not use multiple sockets or adapters. Position the appliance in such a way that you can access the socket where it is plugged in.

## Electrical power

The electrical socket must be able to handle the maximum power load of the appliance, which is indicated on the rating plate located inside the appliance.

**This appliance is not designed to be used as an integrated appliance. It must be installed respecting the conditions indicated in the instruction manual.**

**To avoid a risk due to the instability of the appliance, you must follow up to all the instructions.**

**This appliance must be installed in a place compatible with its climatic class declared on the data label located inside the appliance:**

| Symbol | Climatic Class                 | Minimum ambient temperature | Maximum ambient temperature |
|--------|--------------------------------|-----------------------------|-----------------------------|
| SN     | Extended temperate             | +10°C                       | +32°C                       |
| N      | Temperate                      | +16°C                       | +32°C                       |
| ST     | Subtropical                    | +16°C                       | +38°C                       |
| T      | Tropical                       | +16°C                       | +43°C                       |
| SN-T   | Extended temperate to tropical | +16°C                       | +43°C                       |

Despite this standard range, your appliance will work correctly even in a room with temperature starting from 0°C.

Room relative humidity should be in the range of 50% to 75%. Outside this range the appliance will do his best to bring internal humidity to set point but, depending on the load and temperature set point, this cannot be guaranteed.

## Wall spacer

Before placing your appliance in position, you must install the wall spacer at the top back (E1.0) of the unit. Slightly loosen the two screws, insert the spacer and re-tighten the screws until the part is securely fastened.

## THE APPLIANCE

**A - Temperature and Humidity Controller**  
**B - Switch**  
**C - LED lighting**  
**D - Door lock\***  
**E - Fixed racks\***  
**F - Handle**  
**G - Drawer\***  
**H - Adjustable feet/castors**  
**I - Water discharge opening**  
**J - Carbon filter**  
**K - Fan**  
**L - Sliding racks\***  
**M - Bottom rack\***

### Control panel (A and B)

**1 - Internal temperature display**

**2 - On/Off button**

Press to start or stop the appliance.

**3 - Increase button**

**4 - Decrease button**

**5 - Compressor indicator**

Lights up if the compressor is running, flashes if the "short cycle" delay is active.

**6 - Defrost active**

**7 - Temperature unit**

**8 - Manual defrost**

**9 - Error/alarm indicator**

Lights up if an alarm sounds.

**10 - Internal relative humidity display**

**11 - Humidity unit**

**12 - Configuration indicator**

Temperature/humidity.

**13 - Resistance indicator**

Lights up if the resistor is active.

**14 - Dehumidification in progress**

**15 - Humidifying in progress**

**16 - Fan indicator**

If the fan is running.

**17 - LED indicator**

On if the light is on

**18 - Adjusts the internal temperature**

**19 - Adjusts the internal humidity**

**20 - Charcoal filter knob**

**21 - Resistor**

Displayed if the resistor is heating.

\* Not present in all models.

## SETTING UP THE APPLIANCE

Before starting the appliance, follow the installation instructions (see "Safety" and "Installation").

Before connecting the appliance, clean the compartments and accessories as indicated in "Maintaining the Appliance".

**This appliance should not be turned on right after transportation.** Two hours is the minimum advised time so that the oil from the motor-compressor gets back to its original position.

Remove any packing materials, check if the racks are completely inserted and if the shelves are well supported.

If you need to move or add new shelves, please read how to do so in chapter "Efficient usage of the appliance".

### Checking filter installation

Check if the charcoal filter is aligned and completely inserted in its position and remove any packing materials. (D1.0).

### Checking discharge hole wiper

Drain hole is fitted with a cleaning wiper. Please check if it is in position. (C1.0).

### Starting your appliance

Connect the power cord and wait a few seconds for the controller to start. After start-up, it will show actual internal temperature and humidity\*. Press on (2) if did not start.

Set the controller to the desired temperature if different from default set point 12°C. See sub-chapter "Temperature setting" and "Humidity setting".

### Temperature setting

The default temperature setpoint is 12°C. You can adjust the temperature inside your cabinet within a range of 5 and 20°C. It is not possible to set a temperature outside this range.

Press the temperature setting button (18). The temperature value and the setting warning (12) will start flashing where the setpoint value is displayed.

Adjust the setpoint temperature to the desired value using the

control buttons (3) or (4). Confirm your choice by pressing the button (18).

Controller A: After waiting 10 seconds, the normal display returns. Press and hold the SET button (18) for more than 2 seconds. The setpoint value is displayed and the °C or °F LED flashes. Change the setpoint value with the buttons (3) or (4) within 10 seconds. To store the new value of the setpoint value, press the SET button again or wait for 10s.

Controller B: If the setpoint is not changed within 30 seconds after pressing the setting button (18), the controller returns to the originally stored value and the warning light (12) goes out. If the setpoint is changed but not confirmed, after 30 seconds the controller will assume the new setpoint and return to the temperature display mode.

### Low temperature operation (only for Controller B)

Some cellar are equipped with a frost protection system which enables the cellar to operate in a low temperature environment. In case the ambient temperature is too low (below 10°C) and the appliance is having difficulties in balancing the setpoint value, a low power electrical resistance is activated in order to restore the temperature, avoiding thermal shocks that are harmful to the conservation of the wine.

### Humidity setting (only for Controller B)

Default humidity set point is 65%. In order to keep the sealing quality of the corks and avoid bottle label damage, internal level of humidity should be ideally between 60 and 75%. You can however adjust this set point between 50% and 75%. The appliance will take the necessary actions to adjust internal humidity to set point. Please consider that according to the load and the room conditions, a tolerance of 10% around set point must be considered.

Press the humidity setting key (19), actual humidity set point and signalling light (11) will start blinking.

Adjust to the desired internal humidity using setting keys (3) or (4).

Confirm your choice pressing again the humidity setting key (19).  
It is not possible to adjust relative humidity outside the working range.

**Note: the values read on the controller are the actual temperature and humidity inside the unit, so it is necessary to wait until the new internal conditions are effective.**

**This appliance is designed as an ageing and maturing cabinet and can also be used as a service appliance. All you need to do is set the internal temperature to suit your needs, a white wine should generally be served between 6 and 10°C, reds between 15 and 18°C.**

**You must consider that this appliance is an ageing cabinet, so the temperature change inside is slow. The time required to reach the new setpoints, depending on the internal load and**

**temperature conditions, can be significant.**

### Loading your bottles

Layout must respect the maximum weight allowable per shelf. Bottles must not touch the cabinet rear wall nor the door liner. Weight should be loaded as uniformly as possible, by spreading the bottles and avoiding concentration of the load on the top or the bottom of the appliance.

Sliding shelves should not be loaded with more than two rows of bottles. Top row should be loaded in such a way that sliding the shelf forward will not result in bottle collapse.

Never pull out more than one sliding shelf at a time.

\* Not present in all models.

## EFFICIENT USAGE OF THE APPLIANCE

- It is recommended that your wine cabinet is installed in a temperate room.
- If the internal light is left on, please note that the temperature inside will be higher.
- The temperature inside the wine cabinet can fluctuate depending on the type and number of bottles stored.
- To keep your wines at a stable temperature, avoid leaving the door open for too long.
- Do not install your wine cabinet near a heat source and avoid direct sunlight.
- To ensure your safety and to avoid spoiling the wine, do not place your cabinet in damp areas.
- Do not store perishable foodstuffs in this wine cabinet.
- The wine cabinet is not designed to be used in a garage, outdoors or in the open air.
- The following temperatures (approximate) are recommended for drinking the wine:

| wines                         | Minimum temperature | Maximum temperature |
|-------------------------------|---------------------|---------------------|
| Red vins de pays              | +10°C               | +12°C               |
| White vins de pays            | +8°C                | +10°C               |
| Champanhe                     | +7°C                | +8°C                |
| Vins liquoreux(sweet wines)   | +6°C                | +6°C                |
| Vintage Bordeaux wines - Reds | +16°C               | +17°C               |
| Vintage Burgundy wines - Reds | +15°C               | +16°C               |
| Vintage dry white wines       | +14°C               | +16°C               |
| Light/ fruity / young reds    | +11°C               | +12°C               |
| Provence rosés /Nouveau wines | +10°C               | +12°C               |
| Dry whites                    | +10°C               | +12°C               |

- Temperature stability is most important when it comes to storing wine.
- Exposure to light, vibration or variations in temperature and humidity can spoil the wine.

### The air conditioning system

According to specialists, the ideal temperature for storing wines is around 12°C, within a range of 10° to 14 °C. Not to be confused with the serving temperature, which varies, according to the specific character of each type of wine, from 5 to 18°C.

It is especially important to avoid sudden temperature changes. Designed by specialists, for wine connoisseurs, this appliance, unlike the simple refrigerator, ensures electronic control of a constant average temperature.

### The anti-vibration system

The compressor is equipped with dampers (silent blocks). These

features prevent the transmission of vibrations to the wine.

### The humidification system (only for Controller B)

This appliance is equipped with a tank that maintains the correct level of humidity. If the humidity is too low, fill the tank to  $\frac{3}{4}$  of its capacity (**B1.0**). Check the water level from time to time and add water if necessary. The way the cabinet works means that the tank will always be filled with defrost water.

However, make sure that there is always water in the tank.

### How to fill and maintain your wine cabinet

Here we see 4 types of 75 cl bottles, Burgundy and Bordeaux, of different sizes.

There are many other bottles of all shapes and sizes.

You will note the differences in storage depending on bottle height, diameter and method of crossing.

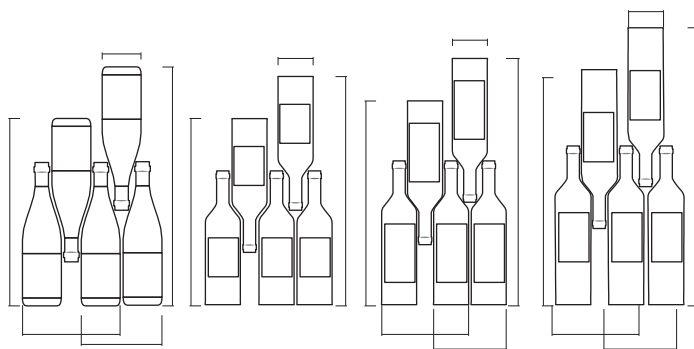

### Loading cabinets

In the fig, **G1.0**, you have some example of standard layouts in combination with different racks that will allow, to reach the best capacity of your cabinet.

Additionally you have more suggestions in **G1.1**.

Additional racks (fixed or sliding) can be purchased from your dealer or after-sales centre to increase the flexibility of your appliance.

### Removing the drawer brackets (A1.1)

Pull the bracket (A1.1.2) upwards to remove the front clip from the side wall, pull the bracket towards you to remove the rear clip (A1.1.1).

Repeat the operation with the bracket on the other side.

### Inserting drawer brackets (A1.1)

Note: pay attention to the positioning, on the right or on the left, of the brackets.

Align the rear clip with the desired hole, push backwards (A) so that the clip fits completely into the slot.  
Align the front clip with the desired slot and push down (B) to fit the clip fully into the slot.  
Make sure that the rack is stable with the side wall.

#### Inserting a drawer(A1.1)

Position the drawer on the runners, push the drawer in.  
Pull out the drawer and the movable runners, fit the fixing screws at the front (A1.1.3) .  
Make sure that the brackets have the vibration dampers installed, put the fixed rack (E) above the dampers, slide backwards so that it fits.

#### Inserting a fixed shelf bracket (A1.2)

Note: pay attention to the positioning, on the right or on the left, of the brackets.  
Align the rear clip with the desired hole, push down to fit the clip fully into the slot (A1.2.1).  
Align the front clip with the desired slot and push down to fit the clip fully into the slot (A1.2.2).  
Make sure that the rack is stable with the side wall.

#### Inserting a sliding rail (A1.0)

Align the rear clip with the desired hole, push backwards so that the clip fits completely into the slot (A1.0.1).  
Align the front clip with the desired slot and push down to fit the clip fully into the slot (A1.0.2).  
Make sure that the rail is stable with the side wall.

#### Removing a sliding rail (A1.0)

Pull the front bracket upwards to remove the front clip from the side wall, pull the bracket towards you to remove the rear clip.

#### Inserting a sliding rack (A1.0)

With the rack tilted (1°), insert it over the rack wheels and slide into the rails (2°).

#### Removing a drawer(A1.1)

Remove the bottles from the drawer and also from the rack above.  
Remove the rack (E) from the top of the drawer.

#### Removing a fixed shelf bracket (A1.2)

Pull the front of the bracket (A1.2.2) upwards to remove the front clip from the side wall, pull the back of the bracket (A1.2.1) towards you to remove the bottom clip.

#### Installing fixed racks (A1.2)

Place the rack on top of the brackets, slide backwards so that it fits.

#### Maximum weight supported per type of rack.

**Caution: Do not exceed the weight indicated in the table below, to avoid breakage of the wooden shelves.**

|                   |       |
|-------------------|-------|
| Fixed racks (E)   | 86 kg |
| Sliding racks (L) | 15 kg |
| Drawer (G)        | 12 kg |

| Model   | Capacity (Bottles) | Fixed shelves (E) | Sliding shelves (L) | Drawer (G) |
|---------|--------------------|-------------------|---------------------|------------|
| 150     | 138                | 2                 | 1                   | 1          |
| 190 SB  | 239                | 3                 | 2                   | 1          |
| 190 FGB | 210                | 3                 | 2                   | 1          |
| 380     | 239+239            | 3+3               | 2+2                 | 1+1        |

## ENERGY SAVING

#### Install the appliance correctly

This means that the appliance should be installed away from sources of heat or direct sunlight, in a well-ventilated room.

#### Shut the doors

Open your appliance only when strictly necessary – every time you open the lid most of the cold air will be lost. In order to restore the correct temperature, the motor will have to run and consume energy.

#### Set the temperature and humidity\*

Observe the recommended ranges, a very high set temperature or internal humidity value will increase energy consumption.

\* Not present in all models.

#### Check the door seals

Keep the seals clean and pliable so that they fit closely against the lid to ensure that no cold air is lost.

## MAINTAINING THE APPLIANCE

**Before doing any cleaning, disconnect the appliance from the electricity (by removing the plug or turning off the main switch in your home).**

#### Defrosting

**WARNING: Do not damage the refrigeration system.**

The interior of the appliance should be cleaned regularly. Use a soft cloth and a mild detergent and water solution. Do not use abrasive products, acetone-based thinners or alcohol-based products.  
Remove all accessories (shelves, drawers, etc.). Wash with warm water and a mild, odourless detergent (e.g. dishwashing liquid), rinse with water and dry thoroughly.

Wash the inside walls in the same way; pay particular attention to the rack brackets.

Wash the door seal and also clean under the seal.

After cleaning the interior, rinse well with clean water and dry thoroughly. When the appliance is cleaned, reconnect your machine

following the instructions in the "Installation" section.

#### Cleaning the condenser

It is recommended that the rear grille (condenser) be cleaned once a year. You can use a vacuum cleaner or a soft brush. This keeps energy consumption low.

#### Prolonged period of inactivity

If the appliance is not used for a long periods, it is advisable to unplug it and leave the door open to prevent the formation of bad odours or mould. Check that the drainage system (I) is clean. If necessary, remove the water with a sponge and clean the hole with the brush provided.

#### Replacing the carbon filter

In order to maintain adequate air quality, the charcoal filter (J) should be replaced once a year. Remove the old filter from the holder and insert the new one, taking care to align it with the fittings.

You can purchase new filters from your dealer. The default period of use is 365 days.

Controller B displays the message "FIL" during filter replacement. If this happens, press any button on the controller to stop the audible alarm, change the filter as indicated and press the filter button (20) to reset. You can change it by pressing the filter button (20) for 3 seconds, pressing the button to increase (3) or decrease (4) the number of days (Controller B). Press the filter button again (20) again to exit settings mode. Selecting zero value (zero days) will disable the filter function.

### Replacing the light bulb

**This appliance contains LEDs (C) of energy efficiency class F for appliances with controller A and energy efficiency class E for appliances with controller B.** Controller B cannot be changed by the consumer. The life of these LEDs is sufficiently long, so that no changes need to be made. If, however, despite all the care taken in the manufacture of this appliance, the LEDs are defective, please contact your After Sales Service for any intervention.

**This appliance is not designed for use as a built-in appliance.**

## TROUBLESHOOTING

### LED light (C) does not light up with the door open

Check if:

- The power cable is not inserted in the socket or not inserted enough to make contact;
- There is no power in the house.

### The wine cabinet is not cooling properly or the compressor is running continuously

Check if:

- The door is closed properly or the seal is damaged;
- The door is opened too frequently;
- The installation conditions are met.

The appliance makes too much noise

Check if:

- The appliance is levelled properly;
- The appliance has been installed between furniture that vibrates and makes noise;
- The installation conditions are met.
- The thermostat is on the right setting;
- The internal fan is free and unobstructed;
- This is the noise made by the refrigerant, which occurs even when the compressor is switched off (this is not a fault).

### The inner rear wall of the appliance is covered with frost or water droplets.

- This is the normal operation of the device.

### There is water in the lower inner part of the appliance

Check if:

- The drain hole is not blocked.

A certain amount of water is normally present in the water drain, which will ensure good moisture control in the appliance.

If, despite all these checks, the appliance still does not work and the problem persists, contact your nearest service centre, indicating: type of fault, model (Mod.) and the Serial Number of the appliance (SN) available on the data plate on the back of the appliance.

**Never use unauthorised technicians and always reject spare parts that are not original.**

### Only for controller B

Check the table codes and corresponding actions:

Controller B will display an alarm or warning code if something is not as expected.

This message will appear alternately with the internal temperature until the alarm conditions stop.

The alarm can be switched off by pressing any key.

Please refer to the table below to understand the meaning of the code and what action to take when it arises.

| CODE | CAUSE                  | ACTION  |
|------|------------------------|---|
| dA   | Door open warning      | Close the door or, if you need to have the door open for a loading/unloading operation, stop the alarm by pressing any button. When you have finished, make sure you close the door and the LED light should go out.                                      |
| FIL  | Carbon filter change   | Change the carbon filter and reset the counter by pressing the filter button (20). See "Maintaining the appliance" for more details. Even if this message appears, the appliance continues to operate normally.   |
| HA   | High temperature alarm | This message appears if the controller is not able to bring the internal temperature to the setpoint. Check if the appliance is installed correctly and that the climatic conditions in the room are as specified (see " <b>Installation</b> " section"). |
| LA   | Low temperature alarm  | If there has been a setpoint change, a large load change or a long door opening, press any key to stop the alarm and allow the cabinet to stabilise. If you are unable to resolve the problem, contact your local after-sales centre.                     |
| HHA  | High humidity alarm    | This message appears if the controller is not able to bring the internal humidity to the setpoint. Check if the appliance is installed correctly and that the climatic conditions in the room are as specified (see " <b>Installation</b> " section).     |
| LHA  | Low humidity alarm     | If there has been a setpoint change, a large load change or a long door opening, press any key to stop the alarm and allow the cabinet to stabilise. If you are unable to resolve the problem, contact your local after-sales centre.                     |

| CODE | CAUSE                     | ACTION  |
|------|---------------------------|---|
| P1   | Thermostat sensor failure | Contact your after-sales service, with this fault your appliance will stop working                  |
| P3   | Humidity sensor failure   | Contact your after-sales service, with this fault your appliance will stop controlling the humidity |

## END OF LIFE AND DISPOSAL OF WASTE MATERIAL

During normal operation, the appliance does not generate any environmental contamination. At the end of its life cycle, or if it is necessary to carry out permanent decommissioning, we recommend the following procedures:

### DISPOSAL (USER):



The symbol, applied to either the product or its packaging, indicates that the appliance contains reusable materials and must be disposed of properly and should not be considered normal household waste. Appliances that are no longer needed must be disposed of in a professional and proper way, in accordance with current regulations and waste legislation, applicable to electrical and electronic appliances. The correct disposal of this product contributes to preventing potential negative consequences that might derive from an inadequate disposal of the product. For detailed information about recycling this product, contact your council, your local waste collection service or the store where you purchased the product.

### PROCEDURE FOR DISPOSAL and RECYCLING AT THE END OF APPLIANCE LIFE SPAN OF THE EQUIPMENT (AUTHORISED BODIES)

- Switch off the equipment and unplug the power supply cable.

- Remove the lamps (if installed). These should be disposed of separately.
- Remove the power units and the electronic cards. These should be disposed of separately.
- Remove all the independent parts (grids, trays, profiles, etc.) and group them according to shared features.
- Remove all mobile parts (doors, sliding doors, glass parts, etc.) and group the various materials according to their features.
- Check the type of refrigerant on the plate located on the back side of the appliance; extract the refrigerant and dispose of it through authorised services.
- Disconnect the evaporator, condenser, compressor, tubes and fans. These are made of copper, aluminium, steel and plastic and should therefore be disposed of separately.
- On removal of all guards and the various components from the frame, separate the different types of material making up the appliance (plastic, sheet steel, polyurethane, copper, etc.) and collect them separately.

**All recyclable materials and waste should be processed and recycled by professionals, in compliance with the laws in the country in question. The company responsible for recycling the materials should be registered and certified as a waste disposal service in accordance with the country in question.**

## CUSTOMER SERVICE

You can solve many problems yourself by consulting the information on "**Troubleshooting**". If this is not the case and you are unable to rectify faults on the appliance yourself or if your appliance needs to be repaired, contact Customer Service.

For safety reasons repairs to the appliance should only be carried out by trained specialist staff. The warranty claim becomes void if repairs or interventions have been carried out by persons not authorized by us for that purpose or if our appliances have been fitted with spare, supplementary or accessory parts that were not genuine parts and then resulted in a defect.

Function-relevant genuine spare parts according to the corresponding Eco-design Order <sup>1</sup> can be obtained from Customer Service for a period of no less than 7 years, from the date on which your appliance was placed on the market within the European Economic Area. To request them simply contact Customer Service indicating the desired part and providing the reference and serial number of the appliance found on the data label located inside the appliance.

Some spare parts are reserved for assembly by accredited professionals and cannot be sold to third parties.

### WARRANTY\*

The minimum duration of the warranty (manufacturer's warranty for private consumers) in the European Economic Area is **2 years**

according to the terms of warranty applicable locally.

Professional repairers can request accreditation contacting the manufacturer or dealer, consulting the data indicated on the data label located inside the appliance. After registration and proof of credentials, all relevant technical documentation will be provided. There may be a cost associated with this process.

The warranty will not apply in case of:

- Normal wear and tear;
- Incorrect use, like overloading of the appliance, use of non-approved accessories, false placement or storage, improper connection or installation;
- Use of force, damage caused by external influences;
- Damage caused by non-observance of the user manual or wrong treatment or operation, connection to an unsuitable mains supply or non-compliance with the installation instructions;
- Partially or completely dismantled appliances.

Detailed information about the warranty period and terms of warranty in your country are available from Customer Service or your dealer.

\* Only applies to countries in the European Economic Area. For countries outside EU, please check locally (local store where your purchase was made) if and how guarantee applies.

## TECHNICAL DATA

Technical information can be found on the technical data label located inside the the appliance and on the energy data label <sup>1</sup>.

**The QR code <sup>1</sup> on the energy label, supplied with the appliance, provides a web link with information related to the appliance's performance in the EU EPREL database <sup>1</sup>.**

To find the product data in the European database (EPREL) <sup>1</sup>, simply read the QR code at the top right of the energy label <sup>1</sup>, provided with the appliance, and the link to the application will open.

**Keep the energy label <sup>1</sup> for reference along with the user manual and all other documents provided with this appliance.**

You can find additional information using the link <https://eprel.ec.europa.eu/> <sup>1</sup>.

<sup>1</sup> Only applies to countries in the European Economic Area

## REVERSING THE DOOR

Operation only possible in reversible versions (F1.0).

**WARNING: Before starting these operations, remember to disconnect the appliance from the power supply (by removing the plug or turning off the main switch in your home) and remove all the bottles inside the appliance.**

- Remove the top of the device starting by unscrewing the screws (F1.0.1) at the back and sliding the top until it comes out of the hooks.

- Place the device horizontally the wall spacer.

- Unscrew the upper axis (F1.0.2) and switch to the opposite side.
- Unscrew the front leveling feet (F1.0.6) and the 4 screws (F1.0.5), releasing the bottom hinge (F1.0.4) from the door.
- Change the axis (F1.0.3) to the reverse side and screw the bottom hinge (F1.0.4) on the opposite side of the cabinet, making the hinge axis (F1.0.3) pass through the door axis. Screw the front leveling feet back in (F1.0.6).
- Return the appliance to the vertical position and screw the top.

**Customer Service:**

[info@winestoragecompany.co.uk](mailto:info@winestoragecompany.co.uk)